



# ASPIRE

— TO MOVE —



## Bedford Court, Bath, BA1

Video and physical viewings available. Studio flat located in the popular Bedford Court development. Offered furnished and available from the 8th September. The flat benefits from a parking space and communal gardens.

Bedford Court is located just off London Road and provides excellent access into Bath city centre. There is a bus stop 0.1 miles away and local shops on London Road including a Morrisons supermarket 0.2 miles away.

**£1,150 PCM**

# Bedford Court, Bath, BA1

- Close to local amenities
- Allocated parking space
- Available 8th September
- Initial contract 12 months
- Studio flat
- Communal garden
- Video viewing available
- Council tax A
- Furnished
- Holding deposit: £265

Video and physical viewings available. Studio flat located in the popular Bedford Court development. Offered furnished and available from the 8th September. The flat benefits from a parking space and communal gardens.

Bedford Court is located just off London Road and provides excellent access into Bath city centre. There is a bus stop 0.1 miles away and local shops on London Road including a Morrisons supermarket 0.2 miles away.

The living accommodation comprises of an open plan kitchen, living, dining, bedroom. A double bed, mattress, bedside tables, wardrobe, tv unit, sofa, and a dining table with chairs are provided. The kitchen area has base and wall units, oven, hob, extractor as well as a fridge with freezer compartment. The bathroom has a shower over the bath, toilet and sink. There is a separate storage cupboard which houses the washer/dryer and hot water tank. The flat benefits from a parking space and a splendid riverside communal garden.

The flat is offered furnished and is available from the 8th September. The flat would best suit a professional couple or single occupier. Students may also be accepted.

Council tax band A: £1404.70

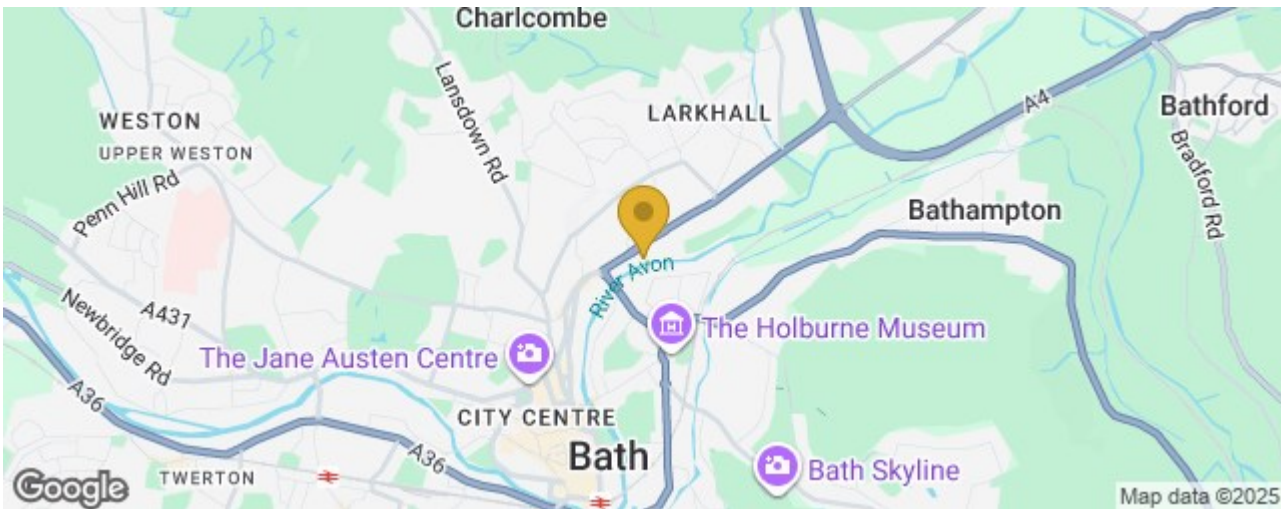





Floor Plan

GROUND FLOOR  
373 sq.ft. (34.7 sq.m.) approx.

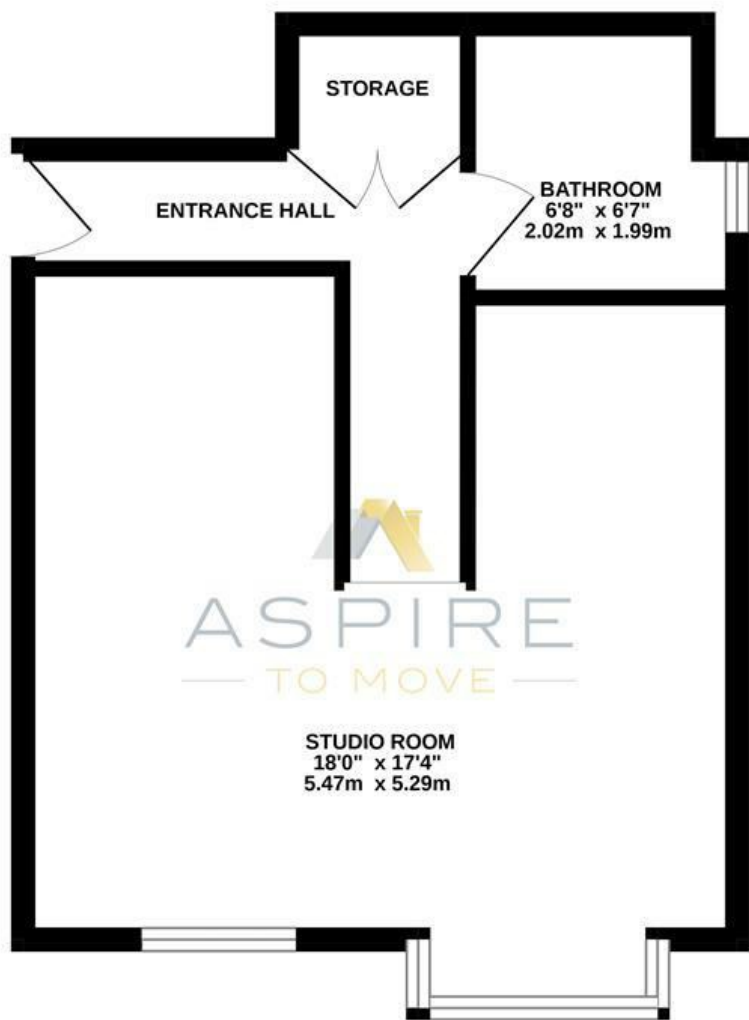

BEDFORD COURT, BATH, BA1

TOTAL FLOOR AREA: 373 sq.ft. (34.7 sq.m.) approx.  
Whilst every attempt has been made to ensure the accuracy of the floorplan contained here, measurements of doors, windows, rooms and any other items are approximate and no responsibility is taken for any error, omission or mis-statement. This plan is for illustrative purposes only and should be used as such by any prospective purchaser. The services, systems and appliances shown have not been tested and no guarantee as to their operability or efficiency can be given.  
Made with Metropix ©2022.

These particulars, whilst believed to be accurate are set out as a general outline only for guidance and do not constitute any part of an offer or contract. Intending purchasers should not rely on them as statements of representation of fact, but must satisfy themselves by inspection or otherwise as to their accuracy. No person in this firms employment has the authority to make or give any representation or warranty in respect of the property.

